

Pos. Nr. Pos. no.	Beschreibung Description	Art.-Nr. Art. no.	Preisgruppe Price bracket
<b>437601 BR 103 DB 103113-7 = HO</b>			
1	LOKGEHAEUSE KPL. Body assembly complete	10437601	038
2	LOKRAHMEN KPL. Loco framework complete	11437601	038
3	FUEHRERSTAND Driver's cab inset	00124375	016
4	LICHTLEITER-SATZ Light conductor set	00134377	011
5	STIRNFENSTER -SATZ Front windows - set	14437601	017
6	HALTETRAVERSE Traverse	00174375	005
7	ISOLATOREN-SATZ Set of isolators	00184376	019
8	PFEIFE Whistle	00194604	003
9	ANTENNE Antenna	00194706	002
10	LAUFDREHGESTELL Bogie	00304375	030
11	KUPPLUNGSADAPTER Coupling adaptor	00384001	006
12	MOTORDREHGESTELL M.SS Motor bogie with interface	04043751	038
13	DREHGESTELLRAHMEN Bogie framework	00414376	017
14	MOTOR KPL.M.SCHWUNGM.M.SS Motor with flywheel, complete, with interface	05043751	035
15	ANKER KPL.M.SCHWUNGMASSE Rotor complete with integr. flywheel	00504607	025
16	LAGERSCHILD ISO.M.SCHNITTST. Motor PCB, insulated, with interface	00504737	020
17	KOHLENROHRKAPPE Brush pipe cap	00504801	002
18	L.RAD M.Z. O.N. Wheel with gear wheel, w/o traction tyre	00514283	008
19	L.RAD O.Z.O.N.ISO ROT Wheel w/o gear wheel, w/o trac. tyre, insul.	00514284	008
20	L.RAD O.Z.M.N.ISO ROT Wheel w/o gear wheel, with trac. tyre, insul.	00514285	008
21	L.RAD M.Z.M.N. ROT Wheel with gear wheel, with traction tyre	00514286	008
22	ACHSE GERAENDELT 20 MM Milled axle, 20mm	00524006	002
23	HAFTREIFEN HO Traction tyre	00544006	001
24	UNTERSETZUNGSRAD Z:28/13 SCHWA Reduction gear wheel	00564102	002
25	ZAHNRAD Z:32 SCHWARZ Gear wheel	00564108	003
26	RITZEL ERS.F.564601 Z:12 MESSI Gear wheel	00564603	004
27	SICHERUNGSRING KLEIN Securing ring, small	00564701	001
28	SICHERUNGSRING GROSS Securing ring, big	00564702	001
	UNTERLEGSCHIEBE ROT 2,2X5X0,5 (o.Abb.) Washer, red (w/o illustration)	00564742	001
	UNTERLEGSCHIEBE 2,3 X 5 X 0,1 (o.Abb.) Washer (w/o illustration)	00564747	001
31	STROMABNEHMER ISOL. Power pick-up, insulated	00614005	007
32	STROMABNEHMER EINSEITIG, ISO. Power pick-up, single sided, insulated	00614006	008
33	STROMABNEHMER Power pick-up	00614012	007
34	STROMABNEHMER EINSEITIG Power pick-up, single sided	00614015	008
35	STROMABNEHMER DOPPELT, ISO. Power pick-up, double sided, insulated	00614017	009
36	MASSEFEDER Ground contact	00614934	001
37	ABDECKBLECH M. FASSUNG Cover sheet with lamp socket	00624375	009

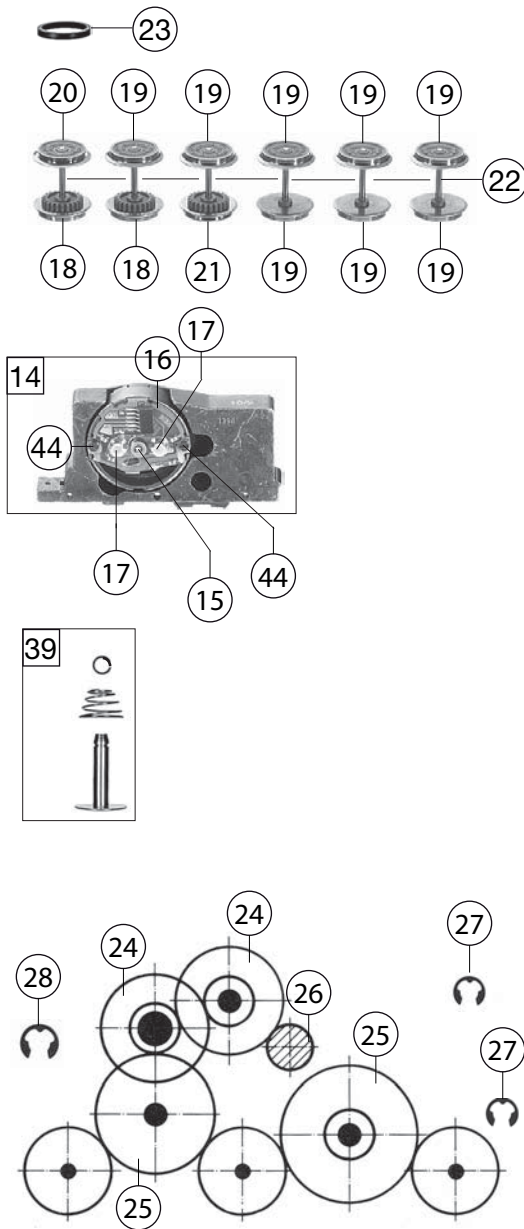

437601		BR 103 DB	103113-7	=	HO
Pos. Nr. Pos.no.	Beschreibung Description	Art.-Nr. Art.no.	Preisgruppe Price bracket		
38	UMSCHALTER Switch	00644375	012		
39	KONTAKTPILZGARNITUR L:10 MM Contacter pin assembly	00644402	011		
40	SCHALTPLATTE PCB	65414500	---		
41	SCHNITTST.-BLINDSTECKER 6-POL. Jumper, 6-pin	00664002	013		
42	EINHOLMPANTO.ROT 4367/76/5106 Single arm pantograph, red	00674320	018		
43	SCHRAUBE Screw	00700307	001		
44	SCHRAUBE Screw	00700313	001		
45	ZYLINDERKOPFSCHRAUBE Cylinder head screw	00700403	001		
46	SCHRAUBE Screw	00713506	001		
47	LINSENSCHRAUBE Button screw	00730005	001		
48	SCHRAUBE Screw	00730007	002		
49	ANSATZSCHRAUBE Flanged screw	00730009	002		
50	ZAPFENSCHRAUBE F.BR 103,150 Shank screw	00730023	002		
51	SPLINT F. KUPPLUNGSADAPT Split pin for coupling adaptor	00730525	001		
52	Steckpuffer Plug-in buffer	00754006	002		
53	BLATTRICHTFEDER L=9.5 MM Flat straightening spring, l=9.5mm	00764008	002		
54	BLATT-ANDRUCKFEDER Flat pressure spring	00764305	001		
	Fleischmann- Steckkupplung (o. Abb.) Fleischmann plug-in coupling (w/o illustration)	6509	---		
	Standard- Steckkupplung (o. Abb.) Standard- coupling (w/o illustration)	6511	---		
	PROFI-STECKKUPPLUNG (o. Abb.) Profi coupling (w/o illustration)	6515	---		
	ERSATZ-SCHLEIFKOHLEN (o. Abb.) Carbon brushes (w/o illustration)	6519	---		
59	ERS.-GLÜHLAMPE M.SCHRAUBFAS. Replacement bulb, with screw base	00006530	007		